

951 Load Stabilizer

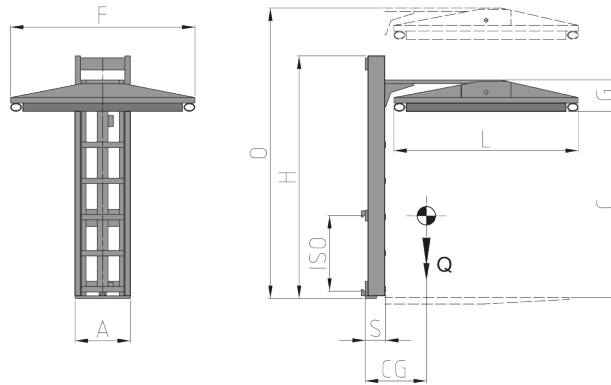

Hydraulic functions: 1 | Max working pressure: 175 Bar

Features:

- Stabilization of unstable/voluminous/overlapping loads on pallets.
- It can be installed on: the original Fork Carriage of the Forklift/Sideshifts/Double or Triple Sideshifts/Fork Positioners/Clamps/Rotators.

Special Equipment:

- Custom made openings, also available with double cylinder.
- Custom made Plate dimensions.

Article	ISO	Opening Range		Frame			Plate Dimensions			Thickness	Centre of Gravity	Weight
		C Min (mm)	C Max (mm)	A (mm)	H (mm)	O (mm)	F (mm)	L (mm)	G (mm)			
N°	2328											
29F52A061	2	1000	1900	300	1300	2035	1000	1000	150	120	255	220
29F52A053	2	1000	1900	300	1300	2035	1000	1150	150	120	270	225
29F52A049*	2	1000	2300	300	1700	2500	1000	1000	150	120	255	245
29F52A035*	2	1000	2300	300	1700	2500	1000	1150	150	120	270	250
29F52A062	2	1100	2200	300	1500	2485	1000	1000	150	120	255	230
29F52A063	2	1100	2200	300	1500	2485	1000	1150	150	120	270	235
29F52A064	2	1200	2100	300	1425	2235	1000	1000	150	120	255	225
29F52A065	2	1200	2100	300	1425	2235	1000	1150	150	120	270	230
29F52A066	2	1200	2200	300	1425	2425	1000	1000	150	120	255	225
29F52A067	2	1200	2200	300	1425	2425	1000	1150	150	120	270	230
29F52A068	2	1200	2300	300	1430	2430	1000	1000	150	120	255	230
29F52A046	2	1200	2300	300	1430	2430	1000	1150	150	120	270	235
29F52A069	2	1300	2200	300	1500	2400	1000	1000	150	120	255	235
29F52A070	2	1300	2200	300	1500	2400	1000	1150	150	120	270	240

* Double Cylinder models

Oil flow rate	
ISO	(L/min)
2	15

 Vertical Clamping

Please refer to our catalogue for further Special Equipment