

474.160 Drum Clamp for one or two Drums

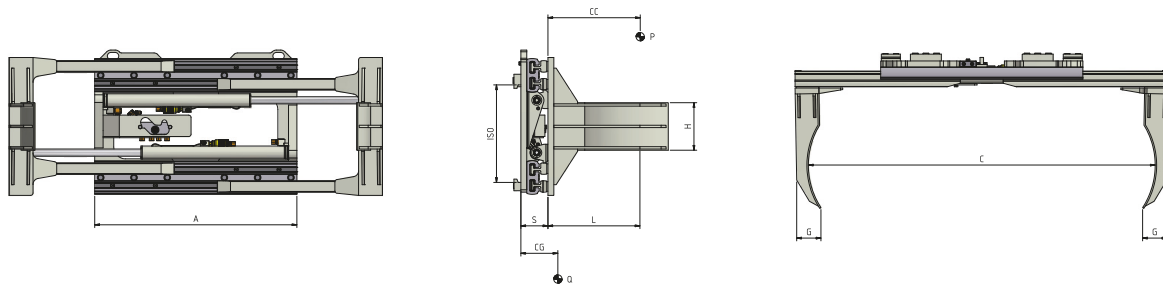

HYDRAULIC FUNCTIONS: 1 | MAX WORKING PRESSURE: 175 Bar

Features:

- Handling of 1 or 2 Drums at once.
- Adjustable clamping force with hydraulic valve.
- Pressure Relief Valve.
- Non-return Valve.
- Regenerative Valve.

Special Equipment:

- Custom made widths/openings.
- Custom made Blades.
- Load Backrest.
- "V" shaped Plates for gripping drums with different diameters.
- Sideshifting Valve or Semi-Integral Sideshift.

ART. N°	P (Kg)	CC (mm)	ISO 2328	A (mm)	C		GxHxL (mm)	S (mm)	CG (mm)	Q (Kg)
					Min (mm)	Max (mm)				
11L23AQ2C0001	1200	500	II	950	490	1730	100x200x330	109	102	230
11L23BE2C0001	1400	500	II	950	450	1600	100x200x330	137	109	316

OIL FLOW RATE

ISO	(L/min)
	II

II Clamping

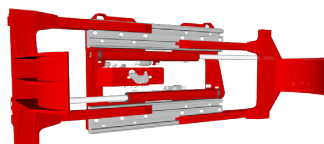

P	ATTACHMENT CAPACITY
CC	LOAD CENTRE OF GRAVITY
A	FRAME WIDTH
C	OPENING RANGE
GxHxL	BLADES
S	THICKNESS
CG	CENTRE OF GRAVITY
Q	WEIGHT

Please refer to our catalogue for further Special Equipment