

976 Fork mounted Crane Jib with extending arm

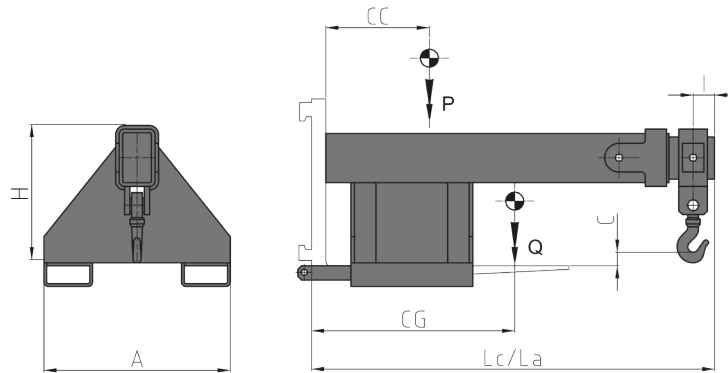

Features:

- Fork mounted attachment.
- Handling suspended loads.
- Use of Belts or Chains.

ART. N°	P (Kg)	CC (mm)	A (mm)	H (mm)	Lc (mm)	La (mm)	I (mm)	C (mm)	CG (mm)	Q (Kg)
45MFA6D001	2500	500	620	481	1376	1976	76	15	540	170
45MHY6D001	3500	500	720	580	1376	1976	76	20	250	250
45MLL6D001	5000	500	720	580	1376	1976	76	20	580	280
45MR04C001	8000	600	830	730	1486	2086	86	20	590	530

NOTE

The forklift on which the Crane Jib is mounted must be approved. The supply of the Crane Jib does not include the documentation required for the approval.

P ATTACHMENT CAPACITY
CC LOAD CENTRE OF GRAVITY
A WIDTH
H HEIGHT
Lc CLOSED ARM LENGTH
La OPEN ARM LENGTH
I HOLE DISTANCE
C HOOK HEIGHT
CG CENTRE OF GRAVITY
Q WEIGHT

Please refer to our catalogue for further Special Equipment