

# Fork Positioners

Fork Positioner that guarantees a constant and synchronized movement of the forks by standard installation of a flow divider. Designed to withstand extreme usage cycles. Customized versions can be manufactured on request, with forks of different sections and lengths and check valve for barrel grabbing. A pressure relief valve is supplied as standard on each model.

## 673FS DOUBLE PIN-TYPE FORK POSITIONER WITH WELDED FORKS

REFERENCE	CAPACITY (P) Kg	LOAD CENTRE (CC) mm	ISO 2328 - FEM	CARRIAGE WIDTH (A) mm	MIN FORK CARRIAGE (B) mm	OPENING RANGE (C MIN) mm (C MAX) mm		FORKS (D) mm	THICKNESS (S) mm	CENTER OF GRAVITY (CG) mm	WEIGHT (Q) Kg
18YFA2A0001	2500	500	II	980	750	360	930	120x40x1200	160	242	235
18YFA2A0002	2500	500	II	1040	750	360	990	120x40x1200	160	241	245
18YFA2A0003	2500	500	II	1100	750	360	1050	120x40x1200	160	239	255
18YFA2A0004	2500	500	II	1150	750	360	1100	120x40x1200	160	237	265
18YLL3A0001	5000	500	III	1150	880	400	1080	150x50x1200	192	262	425
18YLL3A0002	5000	500	III	1250	880	400	1180	150x50x1200	192	255	440
18YLL3A0003	5000	500	III	1350	1000	400	1280	150x50x1200	192	251	455
18YLL3A0004	5000	500	III	1560	1210	400	1490	150x50x1200	192	239	480
18YLL3A0005	5000	500	III	1660	1210	400	1590	150x50x1200	192	234	500
18YLM4A0004	5000	600	IV	1200	900	550	1110	150x60x1200	222	222	565
18YLM4A0005	5000	600	IV	1400	1100	550	1310	150x60x1200	222	220	620
18YR04A0001	8000	600	IV	1740	1450	550	1650	200x60x1200	220	227	750
18YR04A0002	8000	600	IV	1800	1500	550	1710	200x60x1200	220	225	760
18YR04A0003	8000	600	IV	2000	1700	550	1910	200x60x1200	220	219	800
18YR14A0001	8000	900	IV	2200	2070	550	2110	200x70x1200	231	265	880
18YR14A0002	8000	900	IV	2400	2070	550	2310	200x70x1200	231	245	900

Hydraulic functions required: 1 | Maximum working pressure: 80 bar

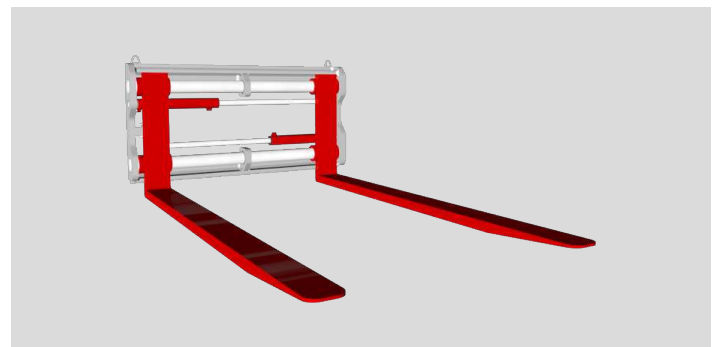
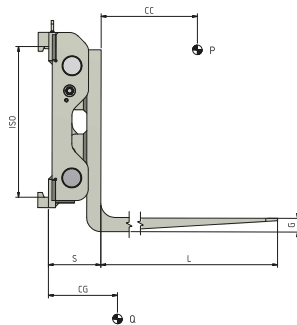
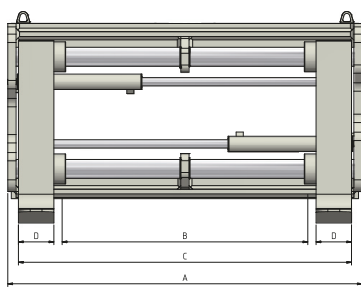

### OPTIONS

- Pipes and Fitting Kit.
- Quick Release Hoses couplings Kit.
- Pressure Gauge.
- Bronze Wear Pads.
- Quick Release Hooks.
- Drilling for Load Backrest.
- Solenoid Valve two Functions with Electric Kit (specify voltage).
- Pressure Relief Valve supplied as standard.
- Check Valve for Barrel Grabbing.
- Sideshifting Valve.
- Semi-Integral Sideshift.
- Automatic Greasing System for Semi-Integral Sideshift.
- Bolt-on forks.

### ADDITIONAL EQUIPMENT ON REQUEST

- Forks Positioners with special width and/or stroke.
- Forks with any section and length.
- Load Backrest of various widths and heights.

### OIL FLOW RATE

TYPE	ISO 2328 - FEM	MIN CAPACITY (L/min)	MAX CAPACITY (L/min)	RECOMMENDED CAPACITY (L/min)
673FS	ISO 2	10	20	15
673FS	ISO 3	15	25	20
673FS	ISO 4 - 18YR0	30	60	40
673FS	ISO 4 - 18YR1	35	60	45

- A - Pin-Type Forks
- B - Bolted Forks
- C - Welded Forks
- D - Telescopic Forks

