

Rotators

Rotator that provides a continuous 360° rotation in both directions. Forks with reinforced lower hooks are required to move the overturned load. Different versions with Pin-Type Forks are also available. Special versions for Foundries, Agricultural or Fishing Industries can be realized on request.

301 360° ROTATORS

REFERENCE	CAPACITY (P) Kg	LOAD CENTRE (CC) mm	ISO 2328 - FEM	CARRIAGE WIDTH (A) mm	HEIGHT (H) mm	MIN FORK CARRIAGE mm	ROTATION CENTER (X) mm	OIL VOLUME (Litres/Turn)	TORQUE Nm P 100 bar	THICKNESS (S) mm	CENTER OF GRAVITY (CG) mm	WEIGHT (Q) Kg
23EC42C0002	1600	500	II	1000	329	580	141	8.1	6700	167	78	184
23EE82C0002	2200	500	II	1100	329	580	141	8.1	6700	167	79	187
23EH23C0002	3000	500	III	1150	369	750	185	8.8	7400	177	80	310
23EHS3C0002	3400	500	III	1270	369	750	185	8.8	12300	177	81	320
23EK63C0024	4200	500	III	1400	369	750	185	8.8	12300	177	83	330
23EL83C0002	4800	500	III	1660	369	750	185	8.8	12300	177	86	340
23EKR4C0001	4500	600	IV	1350	290	1060	235	12	13000	203	93	576
23ELM4C0001	5000	600	IV	1600	290	1060	235	12	13000	203	95	600
23END4C0001	5500	600	IV	1800	290	1060	235	14	14100	203	92	670
23EQ54C0001	7000	600	IV	2000	290	1050	262	18	16200	231	112	838
23ER04C0002	8000	600	IV	2000	290	1050	262	22	24200	231	112	838
23ERQ5C0001	10000	600	V	2000	380	1630	224	26	29500	256	132	1450

Hydraulic functions required: 1 | Maximum working pressure: 175 bar

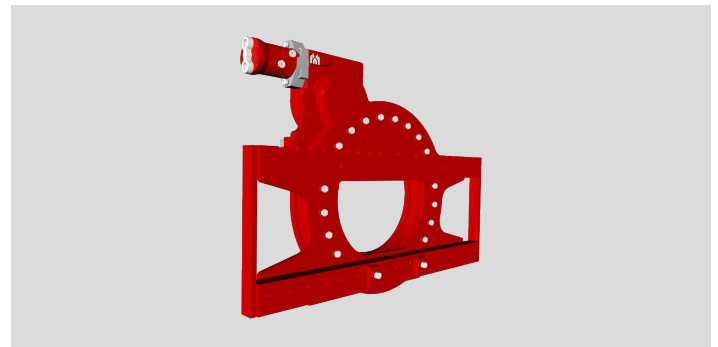
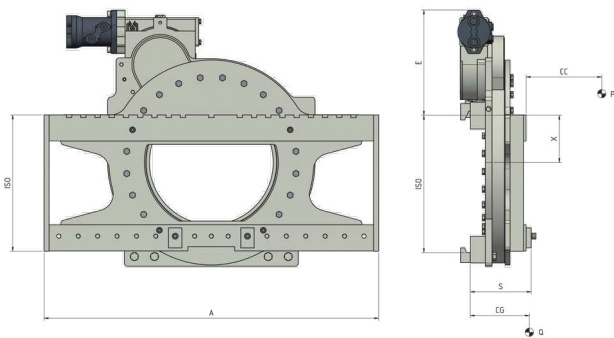

OPTIONS

- Pipes and Fitting Kit. • Quick Release Hoses couplings Kit. • Pressure Gauge. • Bronze Wear Pads. • Quick Release Hooks. • Drilling for Load Backrest. • Solenoid Valve two Functions with Electric Kit (specify voltage). • Pressure Relief Valve. • Check Valve for Barrel Grabbing. • Semi-Integral Sideshift. • Automatic Greasing System for Semi-Integral Sideshift. • Mechanical Block of Rotation at 180°.

ADDITIONAL EQUIPMENT ON REQUEST

- Rotators with special width and/or stroke. • Forks with any section and length. • Load Backrest of various widths and heights. • Pin-Type Fork Connection for ISO 2, 3, 4. • 1000 mm Side Resistant Arm for ISO 2, 3. • Foundry Version (Heat Shield on the Crown) for all types of ISO. • Fishing Industry Version (Heat Shield on the Crown and Anti-Corrosion Treatment) for for all types of ISO. • Motor Protection for for all types of ISO. • Closing of the Central Opening for for all types of ISO. • Central Greasing System with Heat-Resistant Grease for for all types of ISO.

OIL FLOW RATE

TYPE	ISO 2328 - FEM	MIN CAPACITY (L/min)	MAX CAPACITY (L/min)	RECOMMENDED CAPACITY (L/min)
301	ISO 2	10	60	25
301	ISO 3 - 23EHS, 23EK6, 23EL8	10	60	25
301	ISO 4 - 23ELM, 23END	15	60	30
301	ISO 4 - 23EQ5, 23ER0	15	60	35
301	ISO 5 - 23ERQ	15	60	35

A - Pin-Type Forks
B - Bolted Forks
C - Welded Forks
D - Telescopic Forks

